



Permanent magnet alternator

Model 5520

Model 5520 provides electrical power for a FADEC system used on the Ariel 2, a Turbomeca helicopter engine.

The rotor is a sleeved unit employing high energy product magnets. The stator comprises epoxy bonded laminations and dual three phase windings. A cast aluminum housing locates the stator and interfaces with the mounting pad. The alternator is a gear driven from an engine accessory box.

Specifications

Overspeed:

14,139 RPM

Weight:

1.03 lbs

Ambient:

-54 C to 177 C

Altitude:

0 to 50,000 ft

Cooling:

Convection / conduction

Compliance:

MIL-STD-461B
RTCA DO-160C

Electrical:

Dual redundant 3 phase WYE windings

OEKO

Our product competencies and services:
Permanent magnet alternators | Permanent magnet generators | AC/DC brushless starter generators | Aircraft light dimmers
Power supplies | Magnetics | Sensors | Meters

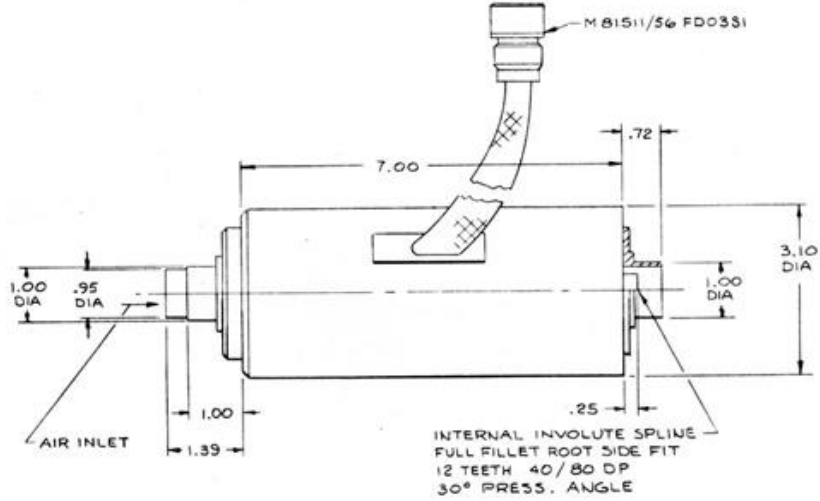

GENERATOR

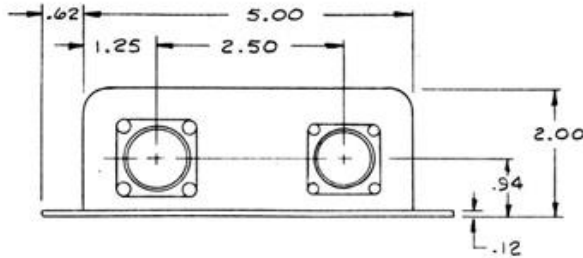
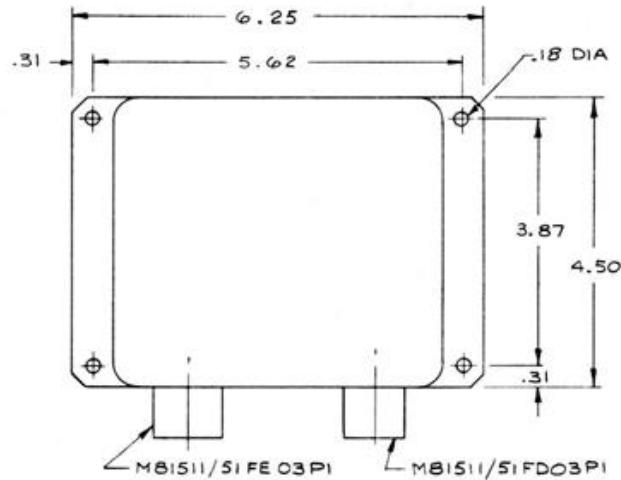

OECO

4607 SE International Way
Milwaukie OR 97222
USA

Tel: +1 (503) 659 5999

www.oeco.com
www.meggitt.com